



# Sikadur® Combiflex®

## High Performance Joint and Crack Sealing System

- Suitable for both new and repair projects
- High joint movement
- Accommodates movement in more than one direction
- Accommodates variations in joint width
- Complies with AS/NZS 4020 for use in contact with potable water
- The Sikadur® Combiflex® system has a proven track record for 30 years



# Sikadur® Combiflex®

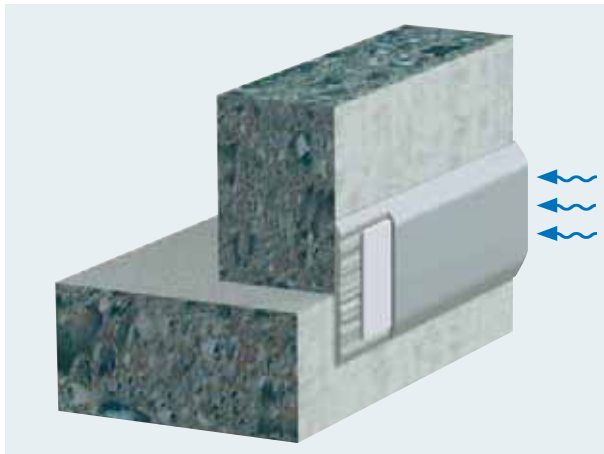

## Function

Sikadur® Combiflex® is a unique joint sealing system that offers extremely high performance properties and long term durability. The system consists of a very flexible Hypalon tape that is securely anchored to the adjoining substrate with Sikadur® 31 high strength epoxy resin adhesive. When installed over a joint it allows considerable movement in more than one direction while maintaining a durable watertight seal.



Drill mixing with paddle

## System Components

### Sikadur® 31 Epoxy Adhesive

To achieve a watertight durable connection between the Sikadur® Combiflex® and the substrate, a 2-component, epoxy-based adhesive is used:

Sikadur® 31

- Extremely easy to apply
- Very smooth surface finish
- Excellent 'bond'



Hot air welding of joint details

### Sikadur® Combiflex® Tape

- Outstanding flexibility
- High durability and chemical resistance
- Weldable; no need for prefabricated fittings
- Excellent bond to Sikadur® 31
- Punched holes provide additional mechanical key

# Sikadur® Combiflex®: Applications

## Movement Joints

- Thermal movement
- Settlement
- Dissimilar material connections
- New to existing structures
- Differential movement
- Variable joint width
- Existing failed joints with unremovable sealant (bitumen, etc)
- Failed waterbars

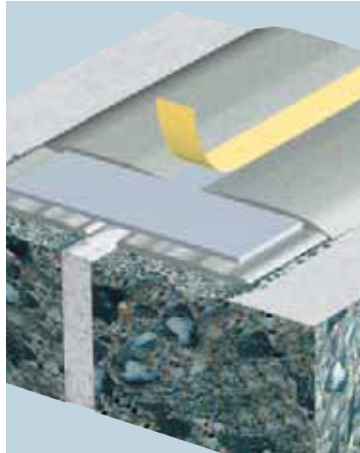

## Construction Joints

- Floor to wall joints
- Wall to wall joints
- Wall to ceiling joints
- Differential material joints
- Concrete day joints
- Can be applied internally and externally

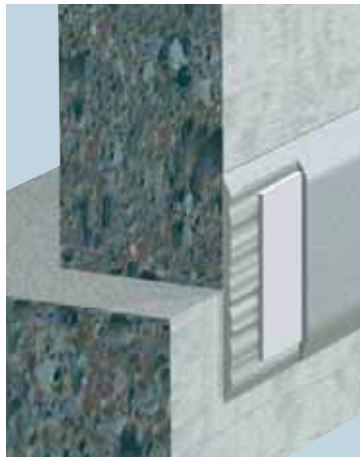

## Crack Sealing

- Construction settlement cracks
- Shrinkage cracks
- Thermal cracks

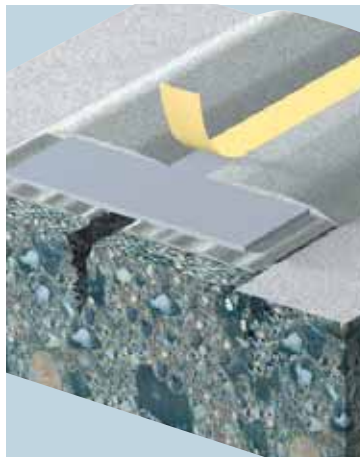

# Sikadur® Combiflex®: Typical Uses



## Potable Water Tanks

- AS/NZS 4020 approved for contact with potable water
- Long term water resistance
- High joint-movement capability
- New and refurbishment projects
- Sikadur® Combiflex® system has a proven track record for 30 years



## Wastewater Treatment Plants and Reservoirs

- Resistant to raw sewage and chemical attack
- Long term immersion tested
- High joint movement capability
- New and refurbishment projects
- Resistant to ozone, chlorine and UV light
- Easily cleaned
- New and refurbishment projects



Conventional sealant after 3-month ozone exposure

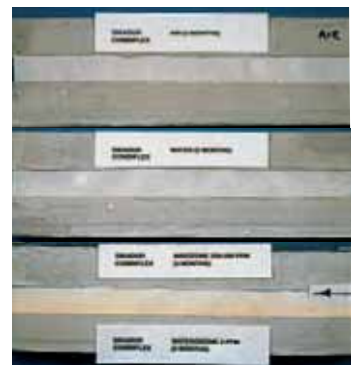

Sikadur®-Combiflex® after 3-month ozone exposure



## Basement Waterproofing

- Durable
- Can be applied to dry or damp surfaces
- Can be applied internally and externally



**SIKA NEW ZEALAND**  
85-91 Patiki Rd, Avondale, Auckland 1026  
0800 SIKa NZ (0800 745 269)  
[www.sika.co.nz](http://www.sika.co.nz)

**SIKA AUSTRALIA PTY LTD**  
55 Elizabeth St, Wetherill Park, NSW 2164  
Tel: (02) 9725 1145  
[www.sika.com.au](http://www.sika.com.au)